

Print Date: 07/11/2017



## City of Napoleon Building Department

255 W. Riverview

P.O. Box 151

Napoleon, OH 43545

Phone: (419) 592-4010

Fax: (419) 599-8393

Email:

### Outside Sewer

Permit Number: P-17-0265

Expiration Date: 07/11/2018

Jane Lighthill

709 BECKHAM ST

Napoleon, OH

**Description:**

\$150.00 Sanitary Sewer Tap  
Charge

---

**Building Permit Info**

Project Description:	New Sewer Tap Installation
Construction Value:	\$4,300.00

A handwritten signature in blue ink, appearing to be 'J. Lighthill', is written over a horizontal line.

Authorizing Signature

2017-10-18

Date

**SCANNED**

MBS 10-18-17

# CITY OF NAPOLEON ZONING PERMIT APPLICATION

THIS APPLICATION IS FOR RESIDENTIAL DEMOLITIONS, FENCES, POOLS, SHEDS,  
DRIVEWAYS, SIDEWALKS & SEWERS

DATE 7-11-17 JOB LOCATION 709 BECKHAM ST.  
 OWNER Jane Lighthill TELEPHONE # 419-980-2100  
 OWNER ADDRESS 2985 E Allen Rd. Defiance 43512  
 CONTRACTOR Vernon Nagel CELL PHONE # \_\_\_\_\_  
 DESCRIPTION OF WORK TO BE PERFORMED NEW SEWER TAP INSTALLATION  
 ESTIMATED COMPLETION DATE \_\_\_\_\_ ESTIMATED COST 4,300.00

DESCRIPTION	FEE	TOTAL COST
Demo Permit	(100.3100.46690) \$100.00	\$
Fence	\$25.00	\$
Pool	\$25.00	\$
Garage and Shed Under 200 SF (Detached)	\$25.00	\$
Driveway	0	\$
Sidewalk/Curbing	0	\$
Sewer Outside	0	\$ <u>150.00</u>
<b>Subtotal:</b>		\$
		\$
<b>TOTAL FEE:</b>		\$ <u>150.00</u>

P-17-0265

**I FULLY UNDERSTAND THAT NO EXCAVATION, CONSTRUCTION OR STRUCTURAL ALTERATION, ELECTRICAL OR MECHANICAL INSTALLATION OR ALTERATION OF ANY BUILDING STRUCTURE, SIGN, OR PART THEREOF AND NO USE OF THE ABOVE SHALL BE UNDERTAKEN OR PERFORMED UNTIL THE PERMIT APPLIED FOR HEREIN HAS BEEN APPROVED AND ISSUED BY THE CITY OF NAPOLEON BUILDING/ZONING DEPARTMENT.**

*I hereby certify that I am the Owner of the named property, or that the proposed work is authorized by the Owner of record and that I have been authorized by the Owner to make this application as his/her authorized agent and I agree to conform to all applicable laws of the jurisdiction. In addition, if a permit for Work described in this application is issued, I certify that the code official or the code official's authorized representative shall have the authority to enter areas covered by such permit at any reasonable hour to enforce the provisions of the code(s) applicable to such permit.*

**I HEREBY ACKNOWLEDGE THAT I HAVE READ AND FULLY UNDERSTAND THE ABOVE LISTED INSTRUCTIONS.**

SIGNATURE OF APPLICANT: Jane Lighthill DATE: 7/11/17

PRINT NAME: Jane Lighthill

BATCH # 37033 CHECK # 01700209 DATE 7-11-17

**931.10 SANITARY SEWER TAP FEES.**

(a) A sanitary sewer tap fee (service connection fee) shall be charged for each connection to the City's sanitary sewer system as follows: (This fee does not cover any labor and material required. Any such labor or materials is a separate charge based on actual cost.)

(b) Charges as contained in this section are applicable and shall be charged for all tributary parcels now in the City to which a sanitary sewer has not been assessed and also for all parcels hereafter annexed to the City. This charge is also applicable and shall be made for all new buildings, major additions, or alterations; to buildings causing increased sewage discharge; any land use causing the discharge of sewage into the sewage system; and any change in sewage flow distribution ordered by the City Manager when the redistribution of sewage flow requires the construction of a new trunk line sewer and a new service connection thereto.

(1) For Lots with single-family dwellings, two family dwellings, or three family dwellings, the sanitary sewer tap charge shall be based upon a minimum of eighty-seven dollars (\$87.00) per 7,200 square feet of land exclusive of dedicated streets, or a charge of eighty-seven dollars (\$87.00) per dwelling unit location, whichever is greater. Anything over the first 7,200 square feet of land shall be on a pro rata basis. However, there shall be a cap to the sewer tap charge as follows:

- A. Single-family dwellings maximum charges is \$150.00;
- B. Two family dwellings maximum charge is \$300.00;
- C. Three family dwellings maximum charge is \$450.00.

(2) For manufactured homes courts, the sanitary sewer tap charge shall be based upon a minimum of eighty-seven dollars (\$87.00) per 7,200 square feet of land exclusive of dedicated streets, or a charge of eighty-seven dollars (\$87.00) per dwelling unit location whichever is greater. Anything over the first 7,200 square feet of land shall be on a pro rata basis.

(3) For all other developments of any kind, excluding commercial or industrial, the sanitary sewer tap charge shall be based upon a minimum of eighty- seven dollars (\$87.00) per 7,200 square feet of land, exclusive of dedicated streets, or a charge of eighty-seven dollars (\$87.00) per dwelling unit location, whichever is greater. Anything over the first 7,200 square feet of land shall be on a pro rata basis.

(4) All commercial or industrial uses: the sanitary sewer tap charge shall be six hundred (\$600.00) dollars.

(5) All sanitary sewer tap fees outside the corporation limits shall be increased fifty percent (50%) from what is stated in this provision.

(c) Inspection fees for sanitary sewer taps shall be as follows:

- |   |  |
|---|--|
| (1) Single-family and duplex residential:   | \$60.00  |
| (2) Multifamily residential, commercial, and industrial fifty feet in length or less:   | \$100.00   |
| (3) Multifamily residential, commercial, and industrial fifty-one feet in length or more:   | \$100.00, plus an additional \$10.00 for each fifty foot increment over and above the initial fifty foot length. |
| (4) Inspection fees outside the corporation limits shall be increased by fifty percent (50%) of the rates established in this inspection fee section. |  |

(Ord. 048-12. Passed 7-2-12.)

Side View

A-12" Clearout to W.M.  
6" Clearout B. 16" W.M. to 6" Tap  
6x67' F/L

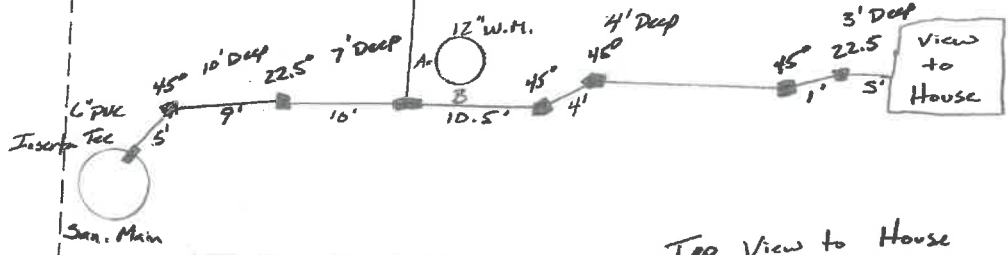

Top View to House

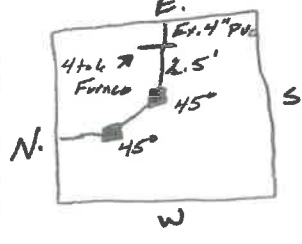

709

6.5' (4")  
Ex. 4" PVC to New 6" PVC with Furnco 2' Deep 4" T.O.P.

12" W.M.

3/4" Steel Gas Main 3' Deep

3/4" Plastic Gas Main 3' Deep

22' East of Manhole  
(6" PVC Inserta Tec)  
16' 6" Deep

12" W.M.

709 Beckham

INSP. ARON DEBLIN  
SEPT. 26, 2017